

STEP 1
POSITION JOINING CHANNEL
INSIDE 'UPRIGHT 1' MAKING SURE
THE JOINING CHANNEL CAN
BE FIXED TO UPRIGHT USING
4X TENSILE BOLTS.

STEP 2
POSITION EXTENSION/ANOTHER
UPRIGHT ON TOP OF UPRIGHT
FIXED WITH JOINING CHANNEL.

SECURE THE EXTENSION/SECOND
UPRIGHT USING 4X TENSILE BOLTS

WALL SYSTEM SECTION VIEW

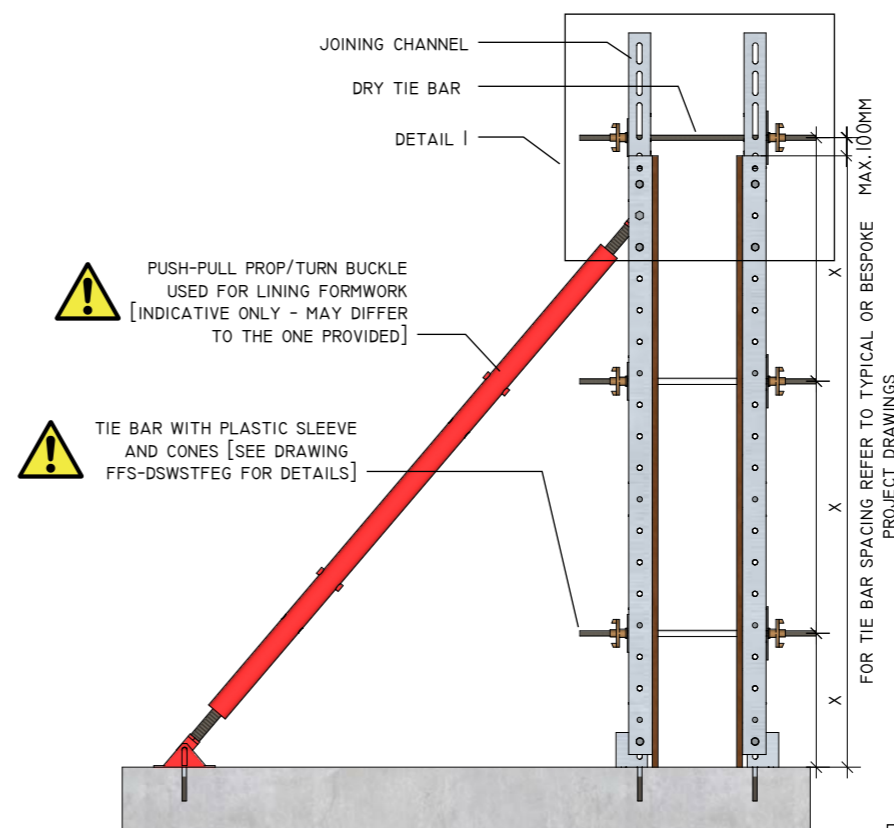

DETAIL I

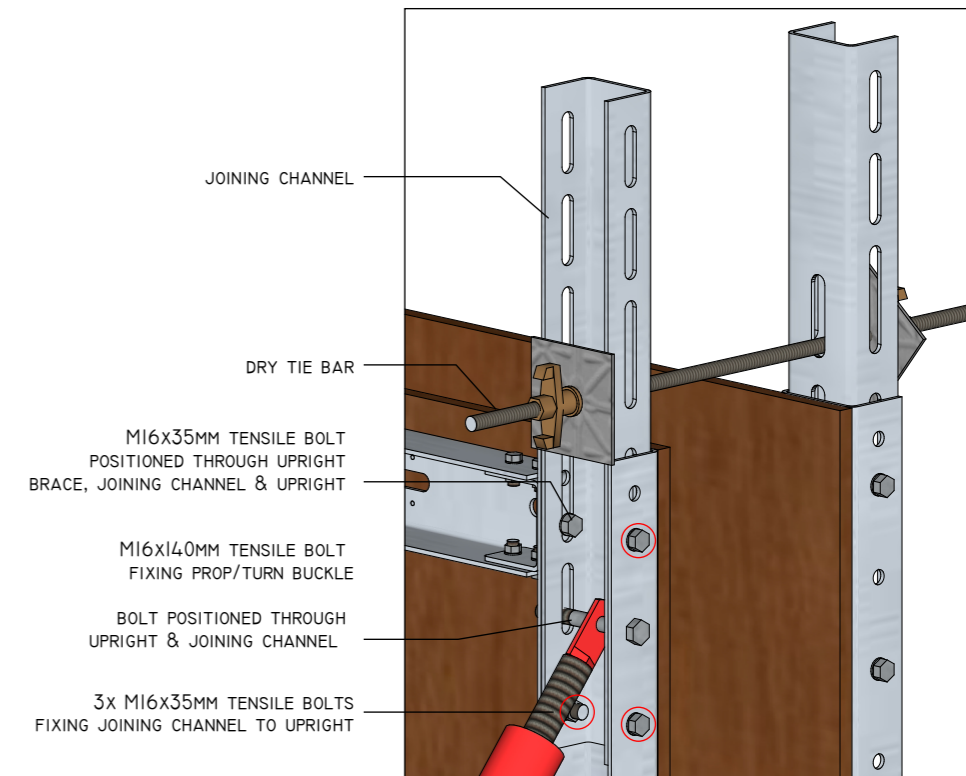

IMPORTANT INFORMATION
JOINING CHANNELS CAN BE USED
TO COMBINE WALL SYSTEM TOGETHER
TO INCREASE POUR HEIGHT.

ALTERNATIVELY JOINING CHANNELS
CAN BE USED TO ALLOW FIXING
OF DRY TIE BAR.

IT IS IMPERATIVE THAT THE DRY
TIE BAR IS POSITIONED NO MORE
THAN 100MM ABOVE THE TOP OF POUR.

THIS METHOD CAN BE APPLIED TO
ALL FAST-FORM WALL SYSTEMS

REVISION	DATE	DESCRIPTION	SIGNED
0	02/08/17	ORIGINAL VERSION	K.P.

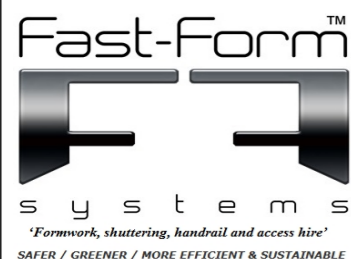

www.fastformsystems.com

info@fastformsystems.com

South Tel: 0207 1481274
North Tel: 08456 171152



Head Office:
Unit 1
Omega Business Park
Estate road 6
Grimsby
N.E.Lincs
DN31 2TG

LEGAL NOTICE:

Fast Form™ is the Trade Mark of Fast-Form Systems Ltd and all designs are copyright and intellectual property of Fast-Form Systems Ltd and may not be reproduced or used without permission. Fast Form™ is covered by the following Patents: granted GB2508263 / GB2533172 Patents Pending GB 1616005.3 / GB 1506126.0 / US-2016-0194887 / PCT W02016 / 110663 / EP 14780541.0 / PCT GB2014 / 052586. Copyright or Trade Mark infringements will be prosecuted, if you see any similar bracket in operation without our name on it please send us an email to info@fastformsystems.com we offer a reward for all successful prosecutions.

Drawn By: Mateusz Jankowski **Date:** 02/08/17 **Rev:** 0

Designed by: Karol Podsiadlo **Drawing no:** FFS-WSJCAIG

Project: Fast Form Wall System

Drawing title: Joining Channel Applications & Installation Guide